

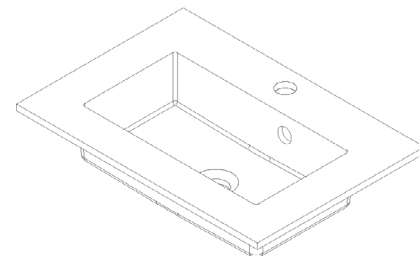

Durasein® Sink & Bowl Information

NAME
THE LARS
MODEL
RLC517
TOLERANCE
±5MM

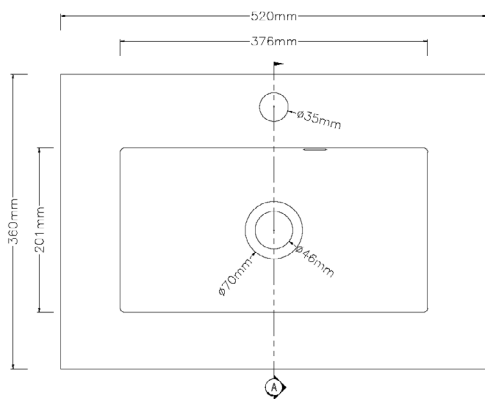

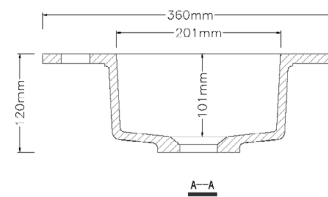
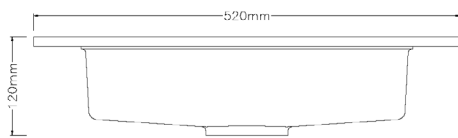
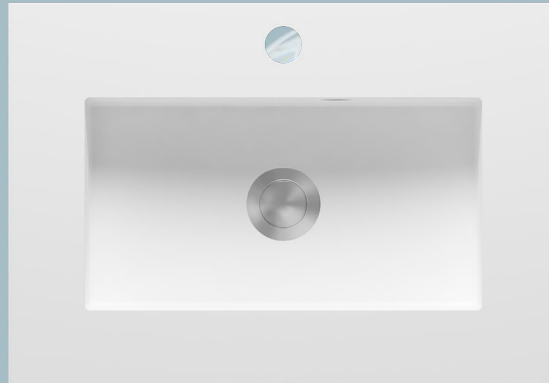

Durasein®

Sink & Bowl Information

MODEL
RLC517

Features & Benefits

- 100% acrylic
- Easy to clean
- Non-porous
- Stain resistant
- Mold & mildew resistant
- Suitable for residential & commercial applications
- Integral overflow : Internal

Installation Tips

- Undermount
- No tap holes
- Drain assembly not included
- Drain hole size: 46mm

Available Colors

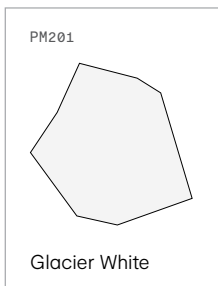

Color shown may vary from actual product. Request sample prior to product selection. We'd love to create something a little more custom for you, longer lead times with minimum order quantity applies.

Codes/Standards/Tech Info

- Durasein sinks and bowls are CE compliant
- All dimensions are nominal
- Details and specifications are subject to change

Internal Dimensions

- Width 376mm
- Height 101mm
- Length 201mm

Durasein® Limited Warranty

- 10 year limited warranty against manufacturing defects under normal use.

See website for detailed warranty information. Durasein reserves the right to make reservations without notice to product specifications. For the most current information, visit durasein.com.