



**Durasein**  
Sinks  
catalog  
2020

—  
Let your  
creativity flow.

—  
Sinks & skills,  
we've got them  
both.



# Your worries, down the drain

## **We've got this, you've got this.**

Sinks and skills – we've got both. We've years of experience designing and manufacturing these shaped delights, everything from bathroom vanities to hospital essentials. We love to collaborate with designers to create sinks that suit any application. Stock or special order, we've got you covered.

For us, design is as important as function when it comes to our sinks. It's what breaks the mold. We don't stop at our high-quality acrylic sinks. Our in-house custom sink design and production capabilities mean we're ready to help you make something special.

Any sink. Any quantity. Anywhere in the world.

## **No idea is too big.**

If you can't find something you love in our standard offering. Give us a shout. Our team of creative customizers here at D.Lab will whip up your wildest creations.



# Durasein

## Sink Information

NAME  
THE FRIDA  
MODEL  
DLA104A  
TOLERANCE  
 $\pm 3/16"$

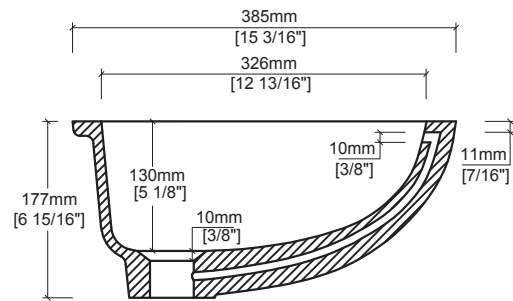
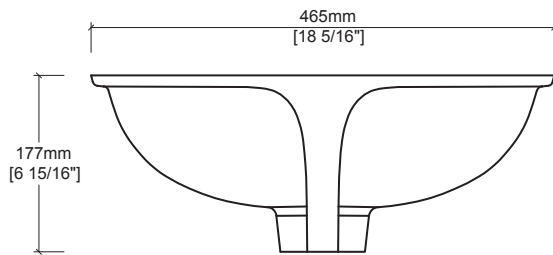

A-A

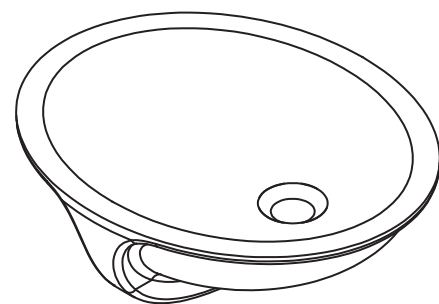
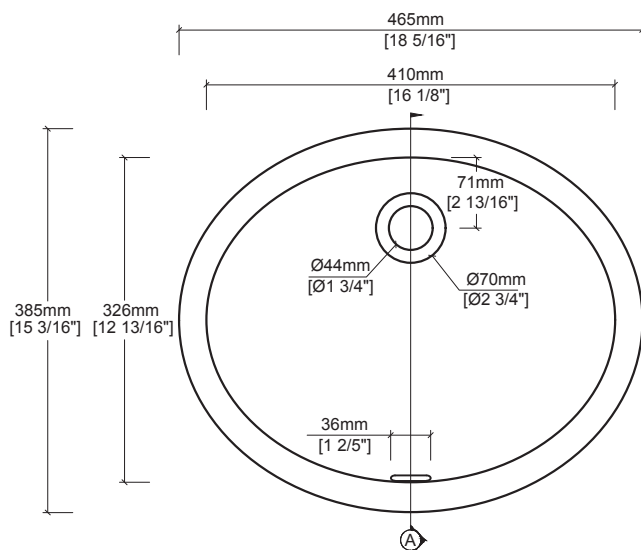



# Durasein

## Sink Information

MODEL  
DLA104A  
DATE  
06.30.20

### Features & Benefits

- 100% acrylic
- Easy to clean
- Non-porous
- Stain resistant
- Mold & mildew resistant
- Suitable for residential & commercial applications
- Integral overflow :: yes

### Installation Tips

- Undermount
- No faucet holes
- Drain assembly not included
- Drain hole size: 1 $\frac{3}{4}$ " (44mm)

### Codes/Standards/Tech Info

- Durasein solid surface sinks and lavatories are certified by Home Innovation Research Labs and tested in accordance with CSA B45.5/IAPMO Z124
- All dimensions are nominal
- Details & specifications are subject to change
- ADA compliant when installed in accordance to ADA guidelines

### Quick Dimensions

- Length: 18 $\frac{5}{16}$ " (465mm)
- Width: 15 $\frac{3}{16}$ " (385mm)
- Height: 6 $\frac{15}{16}$ " (177mm)

### Durasein Limited Time Warranty

- 10 year limited warranty against manufacturing defects under normal use.

See website for detailed warranty info. Durasein reserves the right to make revisions without notice to product specifications. For the most current info, go to [durasein.com](http://durasein.com).

### Available colors



Color shown may vary from actual product. Request sample prior to product selection.  
We'd love to create something a little more custom for you, longer lead times with minimum order quantities apply.



# Durasein

## Sink Information

NAME  
THE ANDY  
MODEL  
DLB379A  
TOLERANCE  
 $\pm 3/16"$

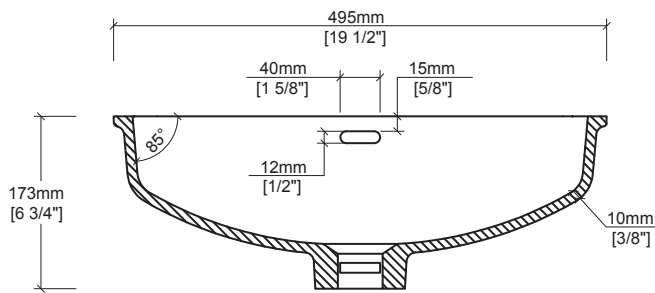

A-A

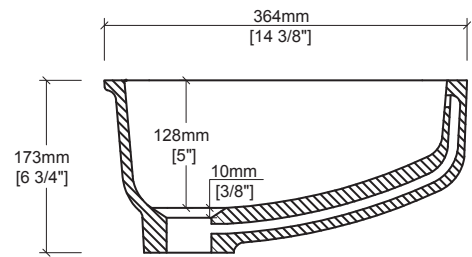

B-B

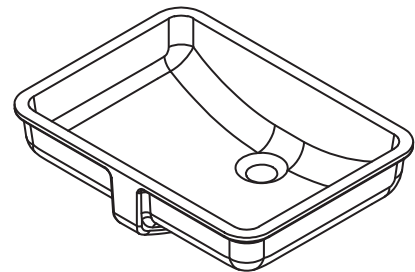
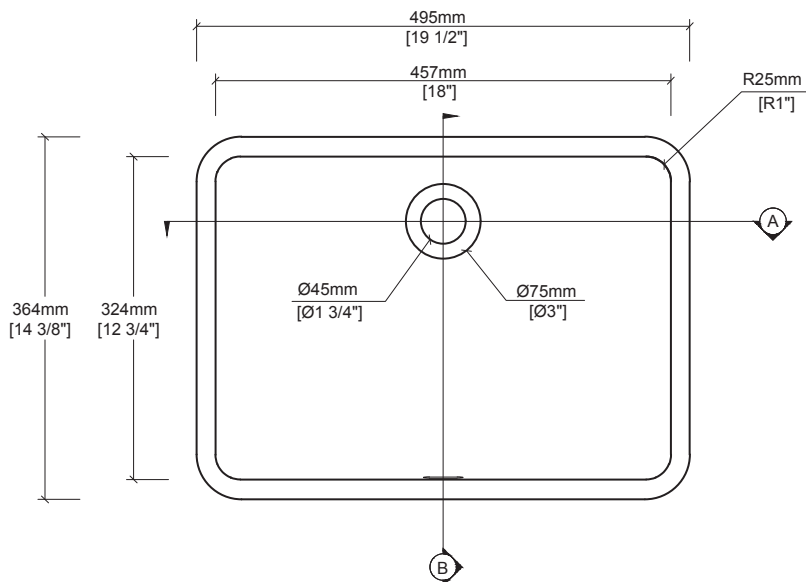



# Durasein

## Sink Information

MODEL  
DLB379A  
DATE  
06.30.20

### Features & Benefits

- 100% Acrylic
- Easy to clean
- Non-porous
- Stain resistant
- Mold & mildew resistant
- Suitable for residential & commercial applications
- Integral overflow :: yes

### Installation Tips

- Undermount
- No faucet holes
- Drain assembly not included
- Drain hole size: 1 $\frac{3}{4}$ " (44mm)

### Codes/Standards/Tech Info

- Durasein solid surface sinks and lavatories are certified by Home Innovation Research Labs and tested in accordance with CSA B45.5/IAPMO Z124
- All dimensions are nominal
- Details & specifications are subject to change
- ADA compliant when installed in accordance to ADA guidelines

### Quick Dimensions

- Length: 19 $\frac{1}{2}$ " (495mm)
- Width: 14 $\frac{3}{8}$ " (364mm)
- Height: 6 $\frac{3}{4}$ " (173mm)

### Durasein Limited Time Warranty

- 10 year limited warranty against manufacturing defects under normal use.

See website for detailed warranty info. Durasein reserves the right to make revisions without notice to product specifications. For the most current info, go to [durasein.com](http://durasein.com).

### Available colors



Color shown may vary from actual product. Request sample prior to product selection.  
We'd love to create something a little more custom for you, longer lead times with minimum order quantities apply.



# Durasein

## Sink Information

NAME  
THE VINCENT  
MODEL  
DLD125  
TOLERANCE  
 $\pm 3/16"$

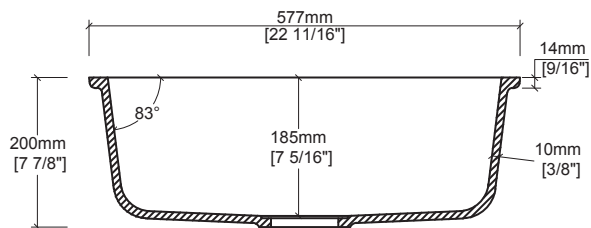

A-A

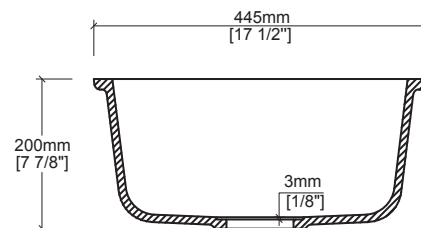

B-B

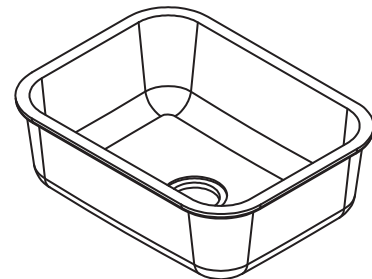
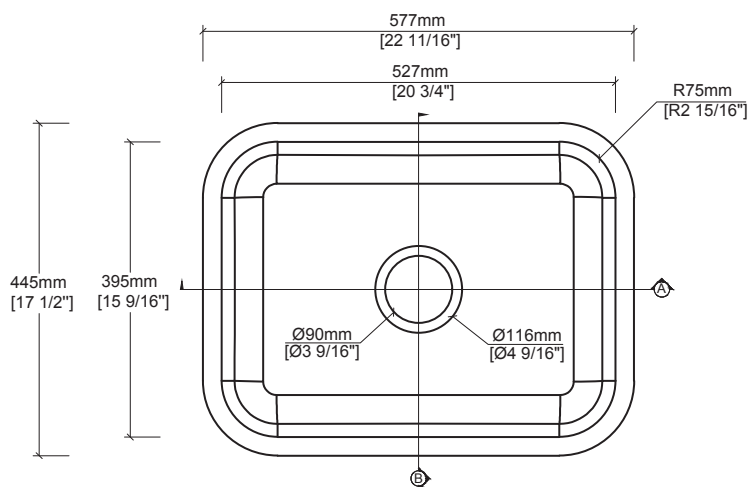





# Durasein

## Sink Information

MODEL  
DLD125  
DATE  
06.30.20

### Features & Benefits

- 100% Acrylic
- Easy to clean
- Non-porous
- Stain resistant
- Mold & mildew resistant
- Suitable for residential & commercial applications
- Integral overflow :: no

### Installation Tips

- Undermount
- No faucet holes
- Drain assembly not included
- Drain hole size: 3½" (89mm)

### Codes/Standards/Tech Info

- Durasein solid surface sinks and lavatories are certified by Home Innovation Research Labs and tested in accordance with CSA B45.5/IAPMO Z124
- All dimensions are nominal
- Details & specifications are subject to change
- ADA compliant when installed in accordance to ADA guidelines

### Quick Dimensions

- Length: 22¼" (577mm)
- Width: 17½" (445mm)
- Height: 7⅞" (200mm)

### Durasein Limited Time Warranty

- 10 year limited warranty against manufacturing defects under normal use.

See website for detailed warranty info. Durasein reserves the right to make revisions without notice to product specifications. For the most current info, go to [durasein.com](http://durasein.com).

### Available colors



Color shown may vary from actual product. Request sample prior to product selection.  
We'd love to create something a little more custom for you, longer lead times with minimum order quantities apply.



# Durasein

## Sink Information

NAME  
THE HENRI  
MODEL  
DLD202  
TOLERANCE  
 $\pm 3/16"$

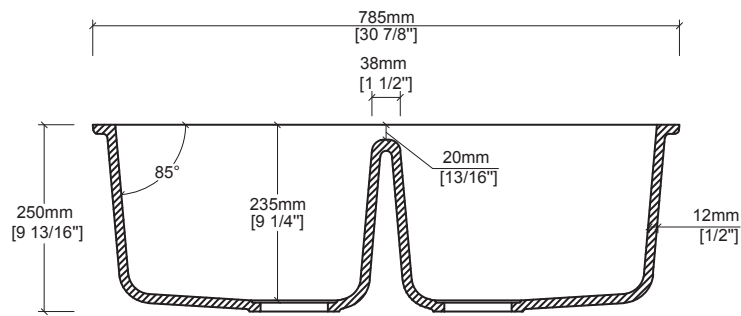
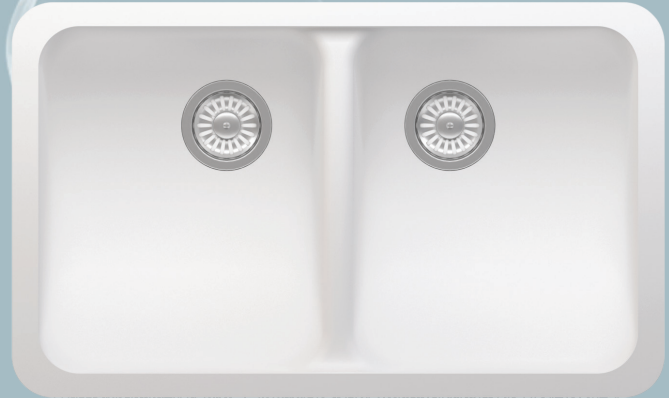

A-A

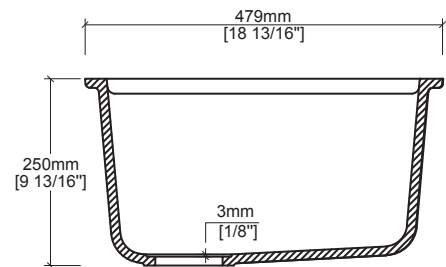

B-B

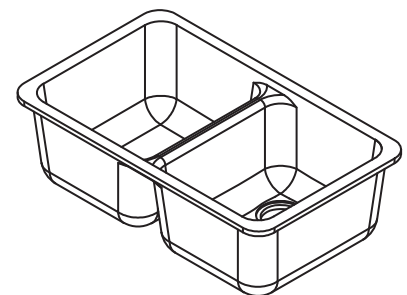
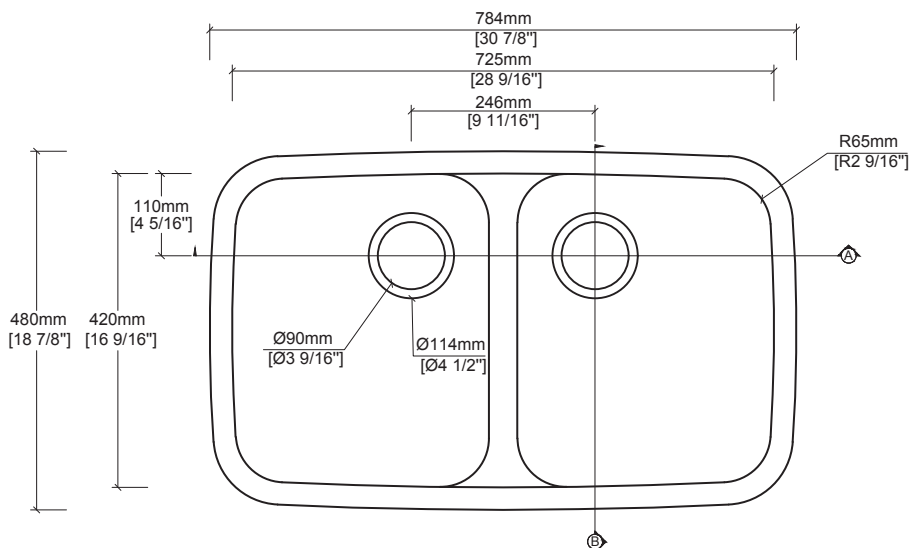



# Durasein

## Sink Information

MODEL  
DLD202  
DATE  
06.30.20

### Features & Benefits

- 100% acrylic
- Easy to clean
- Non-porous
- Stain resistant
- Mold & mildew resistant
- Suitable for residential & commercial applications
- Integral overflow :: no

### Installation Tips

- Undermount
- No faucet holes
- Drain assembly not included
- Drain hole size: 3½" (89mm)

### Codes/Standards/Tech Info

- Durasein solid surface sinks and lavatories are certified by Home Innovation Research Labs and tested in accordance with CSA B45.5/IAPMO Z124
- All dimensions are nominal
- Details & specifications are subject to change
- ADA compliant when installed in accordance to ADA guidelines

### Quick Dimensions

- Length: 30<sup>7</sup>/<sub>8</sub>" (785mm)
- Width: 18<sup>7</sup>/<sub>8</sub>" (480mm)
- Height: 9<sup>13</sup>/<sub>16</sub>" (250mm)

### Durasein Limited Time Warranty

- 10 year limited warranty against manufacturing defects under normal use.

See website for detailed warranty info. Durasein reserves the right to make revisions without notice to product specifications. For the most current info, go to [durasein.com](http://durasein.com).

### Available colors



Color shown may vary from actual product. Request sample prior to product selection.  
We'd love to create something a little more custom for you, longer lead times with minimum order quantities apply.